

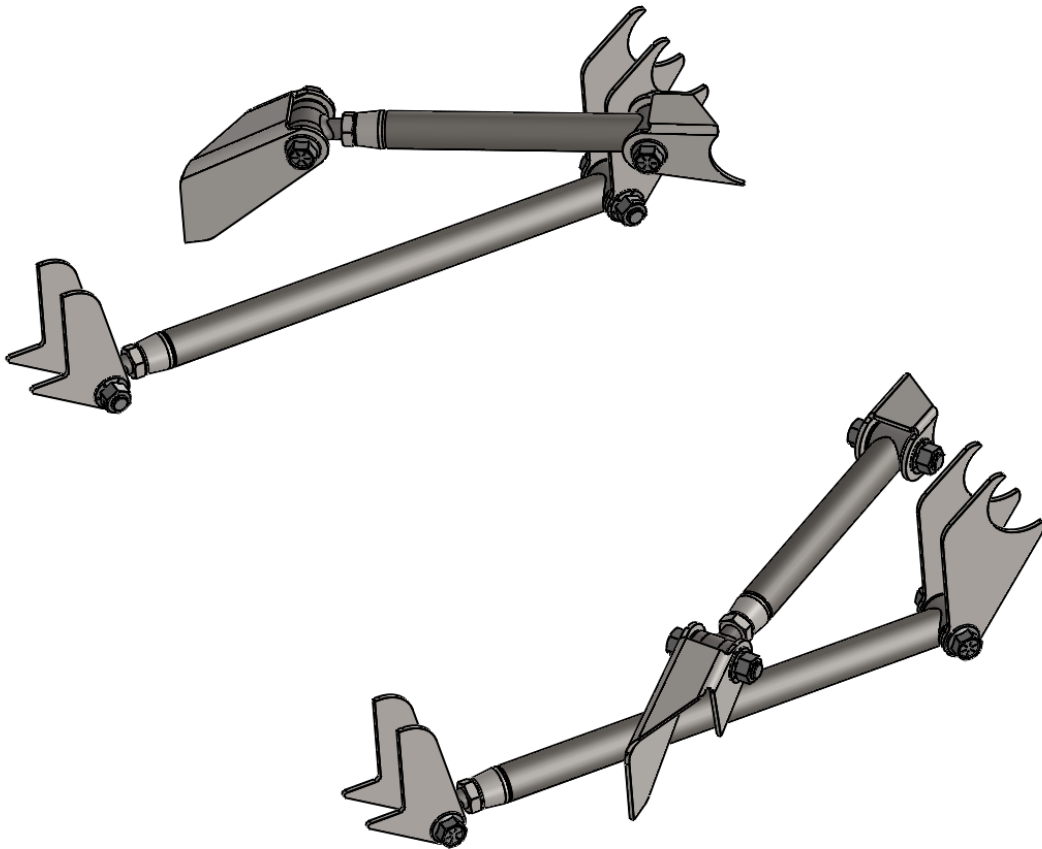

Triangulated 4-Bar Uwelded Kit Instructions

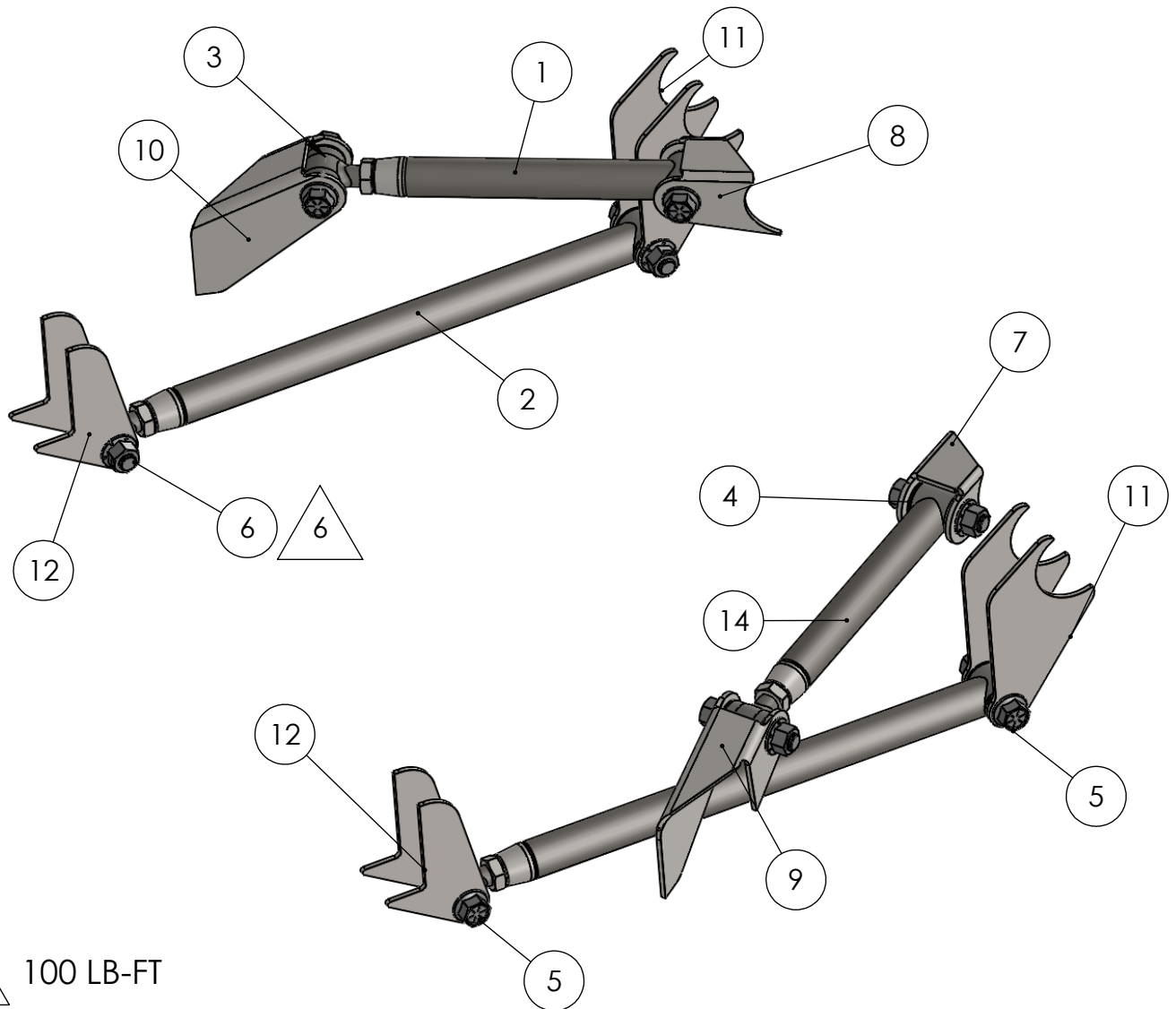



△ 6 100 LB-FT

ITEM NO.	PART NO.	DESCRIPTION	QTY
1	14154511	TRI 4/B UPPER BAR	2
2	14154512	TRI 4/B LOWER BAR	2
3	89890800	POLY RH R/E ASSEMBLY 5/8X3/4	4
4	89890850	POLY R/E BUSHING KIT	4
5	70711255	5/8"-18 X 3" NF GR8 C/S FLANGE MAGNI PLATED	8
6	71715301	5/8"-18 NF HEX GR8 DISTORTED THREAD FLANGE MAGNI PLATED	8
7	14154570	TRI 4/B UPPER HOUSING MOUNT BRACKET LH	1
8	14154571	TRI 4/B UPPER HOUSING MOUNT BRACKET RH	1
9	14154585	TRI 4/B SIDE FRAME MOUNT BRACKET LH	1
10	14154586	TRI 4/B SIDE FRAME MOUNT BRACKET RH	1
11	14150113	TRI 4/B FRONT FRAME BRACKET	4
12	14150123	TRI 4/B LOWER HOUSING MOUNT BRACKET	4
13	14154582	TRI 4/B FRONT FRAME MOUNT GUSSET (NOT SHOWN)	2



Copyright 2012

Triangulated 4/B Unwelded Kit Bill of Materials

11/12/2012

SCALE: 1:6

SHEET 2 OF 4

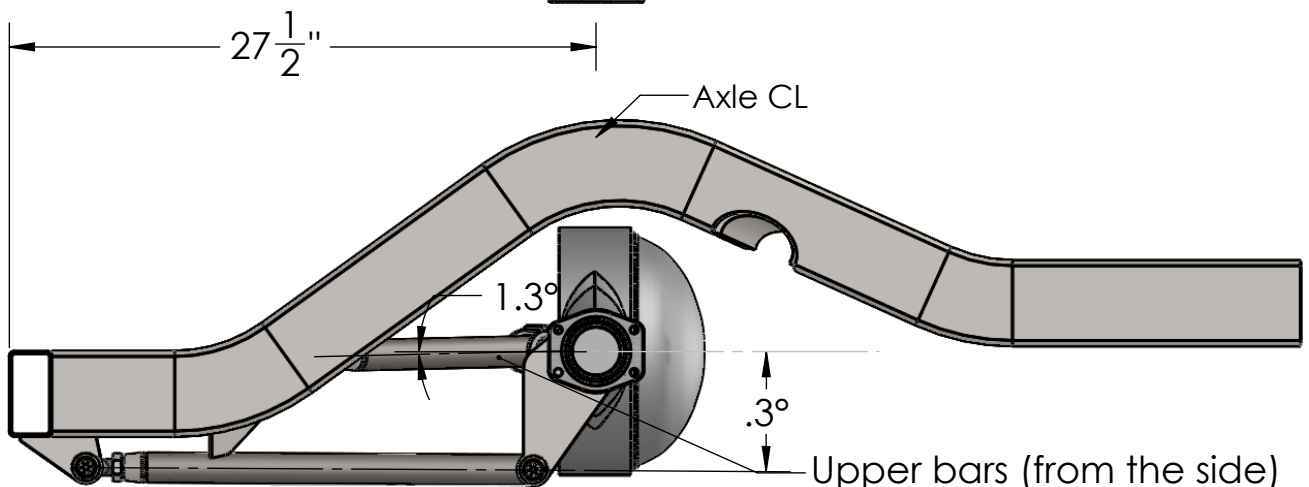
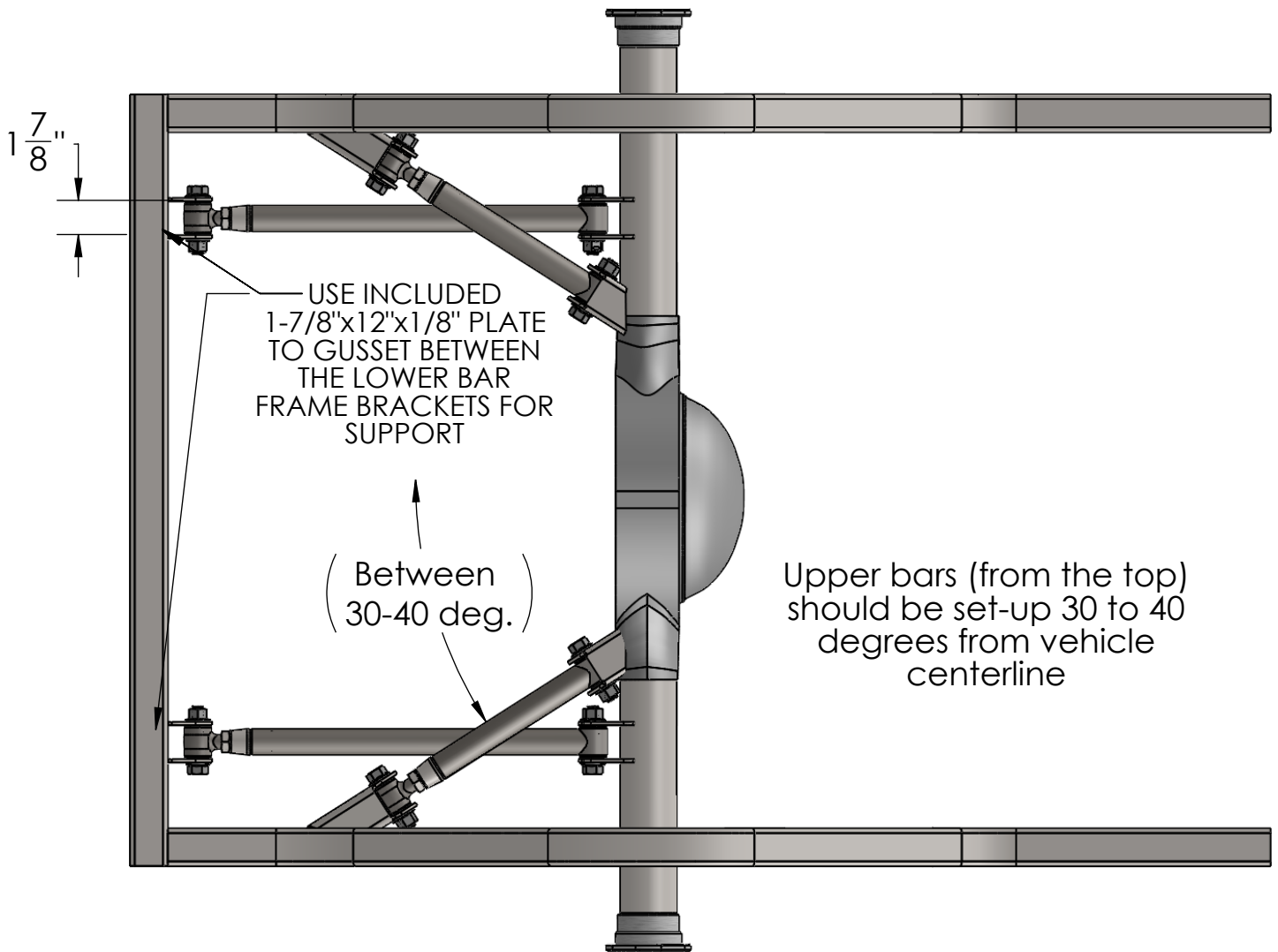

Lower bars should be set-up so that they are from level to slightly up 0.5 degrees to the front

Upper bars (from the side) should be set-up as close to axle centerline height as possible. They should also be angled down from 0.5 to 1.5 degrees towards the front.



Copyright 2012

Triangulated 4-Bar Kit Instructions

11/12/2012

SCALE: 1:9

SHEET 3 OF 4

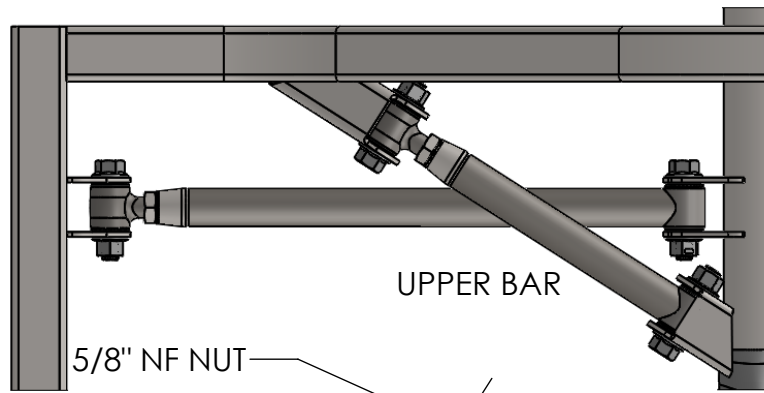

UPPER BAR

5/8" NF NUT

5/8" X 3/4" POLY R/E

5/8" X 3" NF BOLT

12 ³/₄"

NOTE: USE ANTI-SEIZE
PRIOR TO
ASSEMBLING ROD
END TO UPPER BAR

5/8" NF JAM NUT

BUSHING KIT FOR
POLY ROD END

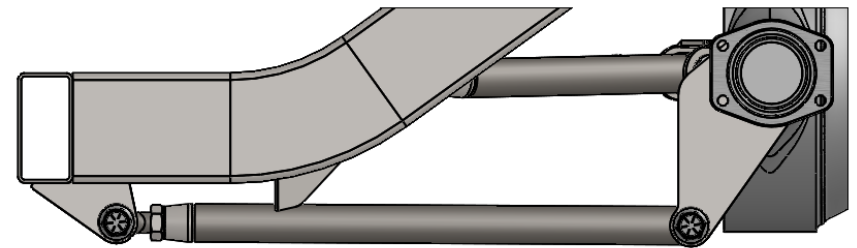

LOWER BAR

21"

5/8" NF NUT

5/8" X 3/4"
STAINLESS POLY R/E

5/8" X 3" NF BOLT

BUSHING KIT FOR
POLY ROD END

NOTE: USE ANTI-SEIZE
PRIOR TO
ASSEMBLING ROD
END TO LOWER BAR

MORRISON



Copyright 2012

Triangulated 4-Bar Kit Instructions

11/12/2012

SCALE: 1:7

SHEET 4 OF 4